

MAXIbrass® CABLE GLANDS

Nickel Plated Brass



2900



Material:
NICKEL PLATED BRASS
(CuZn 40 Pb 3)
Sealing-ring: NEOPRENE®
Cable grip insert:
POLYAMIDE PA6.6
O-Ring: NITRILE 70 sh A
(factory fitted)
Protection: IP 68
Temperature range:
-25°C to +100°C (continuous)

MAXIbrass® standard

Pg thread DIN 40 430

Ref. Nickel Plated Brass	P	Fixing Hole \varnothing (mm)	\varnothing A min-max (mm)	B Spanner (mm)	E (mm)	C (mm)	L min-max (mm)	Quantity
2900.07N	Pg 7	12,5	3 - 7	16	18	5,0	16-20	100
2900.09N	Pg 9	15,5	4 - 8	17	19	6,0	17-23	100
2900.11N	Pg11	19,0	4,5-10	20	23	6,0	20-25	100
2900.13N	Pg13,5	20,5	5 -12	22	25	6,5	20-26	50
2900.16N	Pg16	22,5	7 -13	24	27	6,5	20-27	50
2900.21N	Pg21	29,0	10 -17	30	33	7,0	24-30	50
2900.29N	Pg29	37,0	17 -25	40	45	8,0	30-37	25
2900.36N	Pg36	47,0	20 -32	50	55	8,0	38-48	10
2900.42N	Pg42	54,0	28 -38	57	63	10,0	36-46	5
2900.48N	Pg48	60,0	34 -45	67	74	15,0	40-52	5

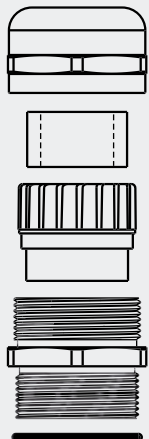
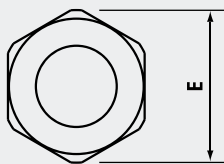
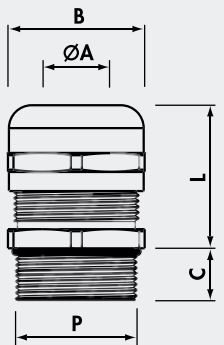

MAXIbrass® reduced cable entry

Pg thread DIN 40 430

Ref. Nickel Plated Brass	P	Fixing Hole \varnothing (mm)	\varnothing A min-max (mm)	B Spanner (mm)	E (mm)	C (mm)	L min-max (mm)	Quantity
2910.07N	Pg 7	12,5	1 - 5	16	18	5,0	16-20	100
2910.09N	Pg 9	15,5	2 - 6	17	19	6,0	17-23	100
2910.11N	Pg11	19,0	2,5- 7	20	23	6,0	20-25	100
2910.13N	Pg13,5	20,5	4 -10	22	25	6,5	20-26	50
2910.16N	Pg16	22,5	5 -10	24	27	6,5	20-27	50
2910.21N	Pg21	29,0	6 -13	30	33	7,0	24-30	50
2910.29N	Pg29	37,0	11 -20	40	45	8,0	30-37	25
2910.36N	Pg36	47,0	18 -26	50	55	8,0	38-48	10
2910.42N	Pg42	54,0	24 -31	57	63	10,0	36-46	5
2910.48N	Pg48	60,0	27 -39	67	74	15,0	40-52	5

MAXIbrass® CABLE GLANDS

Nickel Plated Brass

2900

MAXIbrass® extended thread

Pg thread DIN 40 430

Ref. Nickel Plated Brass	P	Fixing Hole \varnothing (mm)	\varnothing A min-max (mm)	B Spanner (mm)	E (mm)	C (mm)	L min-max (mm)	Quantity
2901.07N	Pg 7	12,5	3 - 7	16	18	12	16-20	100
2901.09N	Pg 9	15,5	4 - 8	17	19	12	17-23	100
2901.11N	Pg11	19,0	4,5-10	20	23	12	20-25	100
2901.13N	Pg13.5	20,5	5 -12	22	25	12	20-26	50
2901.16N	Pg16	22,5	7 -13	24	27	12	20-27	50
2901.21N	Pg21	29,0	10 -17	30	33	12	24-30	50
2901.29N	Pg29	37,0	17 -25	40	45	15	30-37	25
2901.36N	Pg36	47,0	20 -32	50	55	15	38-48	10
2901.42N	Pg42	54,0	28 -38	57	63	15	36-46	5

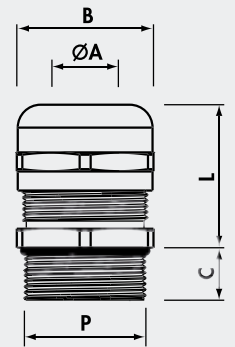

MAXIbrass® extended thread and reduced cable entry

Pg thread DIN 40 430

Ref. Nickel Plated Brass	P	Fixing Hole \varnothing (mm)	\varnothing A min-max (mm)	B Spanner (mm)	E (mm)	C (mm)	L min-max (mm)	Quantity
2911.07N	Pg 7	12,5	1 - 5	16	18	12	16-20	100
2911.09N	Pg 9	15,5	2 - 6	17	19	12	17-23	100
2911.11N	Pg11	19,0	2,5- 7	20	23	12	20-25	100
2911.13N	Pg13.5	20,5	4 -10	22	25	12	20-26	50
2911.16N	Pg16	22,5	5 -10	24	27	12	20-27	50
2911.21N	Pg21	29,0	6 -13	30	33	12	24-30	50
2911.29N	Pg29	37,0	11 -20	40	45	15	30-37	25
2911.36N	Pg36	47,0	18 -26	50	55	15	38-48	10
2911.42N	Pg42	54,0	24 -31	57	63	15	36-46	5

