

HIGH VOLTAGE COPPER TERMINALS

two hole fixing

CA-2M 2A-2M

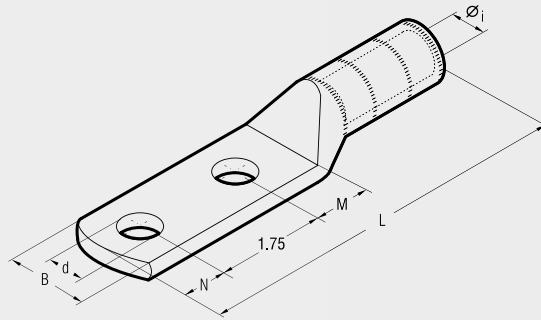

Conductor Size sqmm	Ø Stud in.	Ref.	Dimensions in.						Quantity Box/Bag	Hydraulic Tools					
			Øi	B	M	N	L	d							
25 R	5/16"	CA 25-2 M 8	0.27	0.55	0.39	0.43	4.47	0.33	200/50	B35-50MA	B 55-YC	RHU 81	RHU 81	B1300L-CA and similar tools for U dies	
	1/2"	CA 25-2 M 12	0.27	0.83	0.63	0.55	4.82	0.52	150/50						
30 RC/S ÷ 40 S	1/2"	CA 40 S-2 M 12	0.32	0.85	0.63	0.55	4.86	0.52	100/50						
50 RC	1/2"	CA 50 R-2 M 12	0.34	0.81	0.63	0.55	4.86	0.52	100/50						
50 S	1/2"	CA 50 S-2 M 12	0.37	0.83	0.63	0.55	4.86	0.52	100/50						
63 S ÷ 70 S	1/2"	CA 70 S-2 M 12	0.43	1.02	0.63	0.55	5.03	0.52	50/25						
80 S ÷ 95 RC	9/16"	CA 95 R-2 M 14	0.47	1.10	0.71	0.63	5.49	0.59	30/15						
95 S ÷ 100 S	9/16"	CA 95 S-2 M 14	0.53	1.14	0.71	0.63	5.49	0.59	30/15						
120 RC/S ÷ 150 RC	9/16"	CA 150 R-2 M 14	0.59	1.22	0.71	0.63	5.73	0.59	30/15						
150 S ÷ 160 RC	9/16"	CA 150 S-2 M 14	0.65	1.26	0.71	0.63	5.73	0.59	30/15						
160 S ÷ 200 RC	9/16"	CA 200 R-2 M 14	0.67	1.28	0.71	0.63	5.71	0.59	30/15						
200 S ÷ 240 RC	9/16"	CA 240 R-2 M 14	0.76	1.69	0.71	0.63	5.96	0.59	15/5						
240 S ÷ 315 RC	9/16"	CA 315 R-2 M 14	0.85	1.69	0.71	0.63	5.89	0.59	20/5						
315 S	9/16"	CA 315 S-2 M 14	0.93	1.73	0.71	0.63	5.89	0.59	20/5						
400 R	1/2"	2 A 80-2 M 12	1.06	2.01	0.79	0.55	6.99	0.52	15/5	HT 51	RH 50	B 500A	RHU 81	ECW-H3D	RHU 520
	9/16"	2 A 80-2 M 14	1.06	2.01	0.87	0.63	7.15	0.59	15/5						
	5/8"	2 A 80-2 M 16	1.06	2.01	0.87	0.75	7.26	0.67	15/5						
500 R	9/16"	2 A 100-2 M 14	1.19	2.22	0.87	0.63	7.18	0.59	10/5						
	5/8"	2 A 100-2 M 16	1.19	2.22	0.87	0.75	7.30	0.67	10/5						
600 R ÷ 630 R	9/16"	2 A 120-2 M 14	1.31	2.42	0.87	0.63	7.89	0.59	15/5						
	5/8"	2 A 120-2 M 16	1.31	2.42	0.87	0.75	7.97	0.67	15/5						

R = Round conductors RC = Round Compact conductors S = Sector shaped conductors

CA-2M and 2A-2M Copper Tube Terminal Lugs are designed for high voltage applications up to 33kV.

Manufactured from high purity copper tube, annealed and tin-plated.

The extended barrel enhances electrical and mechanical performance.

The absence of an inspection hole prevents moisture entry into the crimped joint. Featuring an extended palm with two fixing holes at 1.75 in. centres.

Appropriate crimping tools and dies are shown in details on page 204.