

# THROUGH CONNECTORS

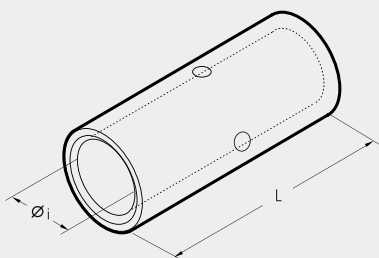

## L-M



Conductor Size sqmm		Ref.	Dimensions mm		Quantity Box/Bag	Mechanical Tools	Hydraulic Tools
low stranded	Flexible		Øi	L			
0,25÷1,5	0,25÷1,5	L 03-M	1,8	15	6.000/100		
1,5÷2,5	1,5÷2,5	L 06-M	2,4	15	4.000/100		
4÷6	4÷6	L 1-M	3,6	22	2.000/100	HN 1	
10	10	L 2-M	4,6	25	1.000/100		
16	16	L 3-M	5,8	27	1.000/100	HN 5	
25	25	L 5-M	7,0	29	500/100		
35	25÷35	L 7-M	8,9	33	400/100	TN 70 SE	B 15D
50	35÷50	L 10-M	10,0	37	200/50	TN 120 SE	B 35-45D
70	50÷70	L 14-M	11,3	39	200/50		B 35-50D
95	70÷95	L 19-M	13,5	43	100/25		HT 45E
120	95÷120	L 24-M	15,2	47	100/25		HT 51 RH 50 B 51 B 55
150	120÷150	L 30-M	16,7	58	50/25		HT 81-U RHU 81
185	150÷185	L 37-M	19,2	64	50/25		HT 120 and tools and heads with 130 kN crimping force
240	185÷240	L 48-M	21,1	75	30/15		ECW-H3D
300	240÷300	L 60-M	23,7	90	20/10		RHU 520
400	300÷400	L 80-M	27,0	94	20/5		
500	400÷500	L 100-M	30,3	98	12/1		
630	500÷630	L 120-M	33,4	105	12/6		
800	600	L 160-M	38,0	112	9/3		
1000	800	L 200-M	44,0	120	6/1		

L-M range of connectors are designed for jointing low voltage conductors. Made of electrolytic copper tube having the same dimension as A-M series lugs: L-M connectors are annealed and electrolytically tin plated. They feature an internal taper at both ends to ease the introduction of the conductor and a central stop to ensure correct positioning.

# PARALLEL CONNECTORS

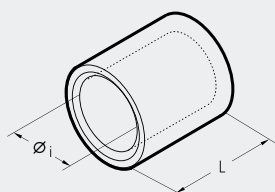

## L-P



Total Conductor Size sqmm		Ref.	Dimensions mm		Quantity Box/Bag	Mechanical Tools	Hydraulic Tools
low stranded	Flexible		Øi	L			
0,25÷1,5	0,25÷1,5	L 03-P	1,8	6,0	10.000/100		
1,5÷2,5	1,5÷2,5	L 06-P	2,4	6,0	5.000/100		
4÷6	4÷6	L 1-P	3,6	9,0	3.000/100	HN 1	
10	10	L 2-P	4,6	10,5	3.000/100		
16	16	L 3-P	5,8	11,5	2.000/100	HN 5	
25	25	L 5-P	7,0	13,0	1.500/100		
35	25÷35	L 7-P	8,9	14,0	500/100	TN 70 SE	B 15D
50	35÷50	L 10-P	10,0	16,0	500/100	TN 120 SE	B 35-45D
70	50÷70	L 14-P	11,3	18,0	500/100		B 35-50D
95	70÷95	L 19-P	13,5	19,0	300/50		HT 45E
120	95÷120	L 24-P	15,2	22,0	200/50		HT 51 RH 50 B 51 B 55
150	120÷150	L 30-P	16,7	26,5	100/50		HT 81-U RHU 81
185	150÷185	L 37-P	19,2	26,5	100/50		HT 120 and tools and heads with 130 kN crimping force
240	185÷240	L 48-P	21,1	34,0	60/15		ECW-H3D
							RHU 520

Made of electrolytic copper tube, having the same dimensions as A-M series lugs, L-P connectors are annealed and electrolytically tin plated. They feature an internal taper to ease the introduction of the conductor.